

## Highlights:

- Energy efficient
- Easy maintenance
- Extremely compact
- Energy efficient
- Extensive accessories, such as our pneumatic intake valve boost (PSVA)
- Low noise

## DP 212 | Technical data

### High-pressure triplex plunger pump

Nominal pressure (bar)	Plunger diameter (mm)	Effective volume flow (l / min)										
		136	152	171	191	216	242	270	300	337	377	425
1000	60	136	152	171	191	216	242	270	300	337	377	425
800	65	163	182	205	229	259	291	324	360	404	*	*
630	75	222	248	279	312	352	396	451	501	560	631	711
500	85	290	323	365	407	467	522	585	650	727	819	923
400	95	368	410	465	523	590	659	739	821	918	1034	*
320	105	459	512	574	645	728	814	912	1013	1109	1249	1407
250	120	606	676	758	851	961	1074	1172	1302	1464	1623	1828
200	135	775	864	969	1089	1191	1338	1499	1648	1843	2076	2339
120	150	932	1039	1165	1309	1478	1651	1851	2056	2299	*	*
Pump speed (min <sup>-1</sup> )		148	165	186	209	236	265	297	330	371	418	471
Shaft power (kW)		291	324	366	406	459	515	571	635	714	813	916

The specified values are based on continuous operation and using water as a working medium.

\* Non-standard versions on request.

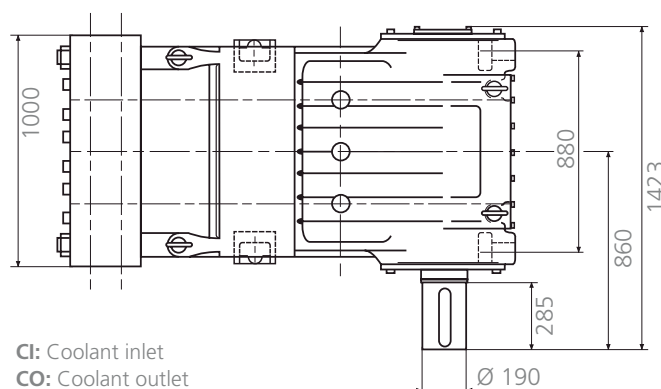
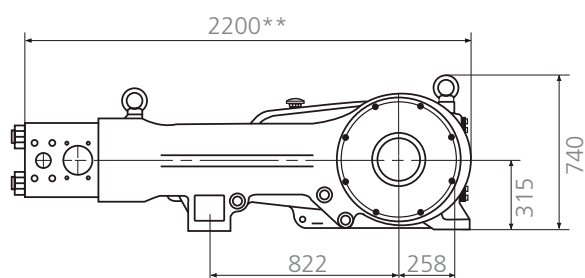

CI: Coolant inlet  
 CO: Coolant outlet  
 B: 4x fixing hole dia. 17 mm

Version with integrated water cooling  
 Weight: approx. 260 kg

All dimensions specified in mm.

## Application examples

- Hydraulic drives
- Descaling
- Industrial cleaning
- Deburring
- Hydroentanglement
- And many more applications



Descaling



Forging press drives

Is your application not mentioned here?

Please give us a call. We'll be pleased to advise you.

## Design features

- Extremely compact design
- Robust construction suitable for continuous and intermittent operation
- Easily accessible valve inserts
- Excellent suction capacity
- Plungers made of coated stainless steel, ceramic or other high-grade materials
- Low-maintenance drive unit
- Start-up under load possible
- Self-adjusting maintenance-free high-pressure seal
- Maintenance-free low-pressure seal
- Quick-release piston clamp for rapid assembly and maintenance

## Accessories

- Pneumatic intake valve boost
- Safety valve
- Recirculating valve
- Pressure regulating valve
- Shut-off valve
- Check valve
- Pressure oil lubrication
- Pulsation damper
- Water or air cooling
- Sound insulation
- Filter units
- Pump controller
- System accessories
- Diagnostic aid
- Further accessories on request

## Drive options

- Compact V-belt drive (vertical design)
- V-belt drive
- Gearbox with or without couplings
- Vertical gearbox
- Direct drive (with or without frequency converter)



**Wepuko PAHNKE GmbH**  
Max-Planck-Str. 10  
72555 Metzingen  
Germany

Tel.: +49 7123 1805-0  
Fax: +49 7123 41231  
wepuko@wepuko.de  
www.wepuko.com

